

MAINTENANCE OF TRAFFIC - PHASE 1C

LEGEND:

- ① 4" CONST. PAVEMENT MARKING, WHITE (TYP.F, CLASS II) Req'd.
- ② 8" CONST. PAVEMENT MARKING (TYP.F, CLASS II) Req'd.
- ③ 24" CONST. PAVEMENT MARKING (TYP.F, CLASS II) Req'd.
- ④ 4" CONST. PAVEMENT MARKING, YELLOW (TYP.F, CLASS II) Req'd.
- ⑤ 4" CONST. PAVEMENT MARKING, DOUBLE YELLOW (TYP.F, CLASS II) Req'd.
- ⑥ 4" CONSTRUCTION PAVEMENT MARKING (TYP.F, CLASS II) 2' LINE, 4' GAP REQ'D.
- ▬ IMPACT ATTENUATOR SERVICE - TYPE I-A
- ▬ PRECAST TRAFFIC BARRIER SERVICE CONCRETE
- ⊕ STD. TYPE III BARRICADE Req'd.
- GROUP 2 CHANNELIZING DEVICE Req'd. (20' SPACING TRANSITION; 40' SPACING TRAVELWAY)
- ▨ PERMANENT CONSTRUCTION THIS PHASE
- ▩ PERMANENT CONSTRUCTION PREVIOUS PHASE
- ▨ TEMPORARY PAVEMENT THIS PHASE
- ➔ MOT TRAFFIC DIRECTION
- ⇄ EXISTING TRAFFIC DIRECTION
- PROPOSED SIGN

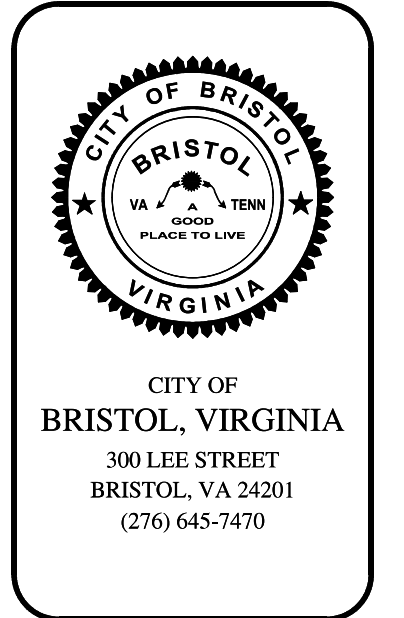
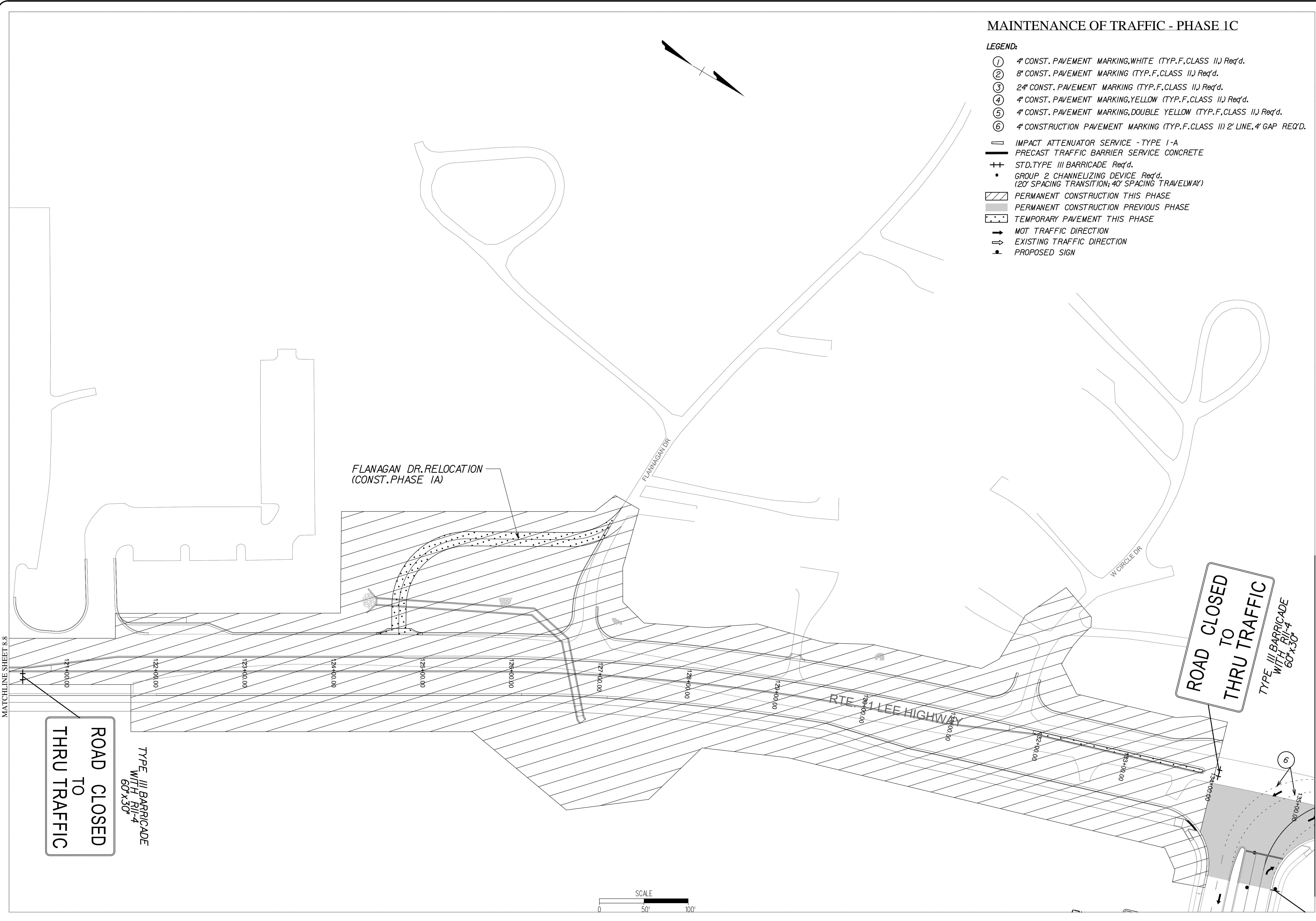

REVISIONS

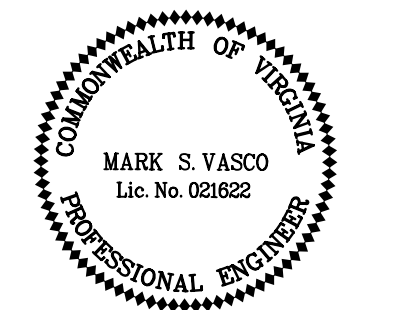

WIDENING OF
LEE HIGHWAY
MOT
UPC 105753

MAINTENANCE
OF TRAFFIC
PHASE 1C

DATE:
MAY 2017
DRAWING NO.
XXX-XXX
FILE NAME:
LEE HWY EXIT 5

SHEET NUMBER
8.9 OF 11

7/17/2017