

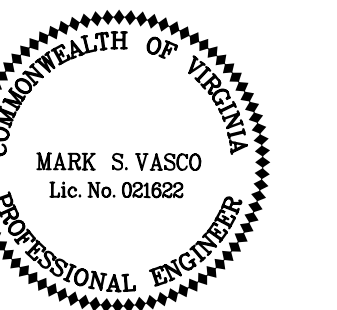

CITY OF  
BRISTOL, VIRGINIA  
300 LEE STREET  
BRISTOL, VA 24201  
(276) 645-7470

REVISIONS	
DATE	



WIDENING OF  
LEE HIGHWAY  
MOT  
UPC 105753

MAINTENANCE  
OF TRAFFIC  
PHASE 1C

DATE:  
MAY 2017  
DRAWING NO.  
XXX-XXX  
FILE NAME:  
LEE HWY EXIT 5

SHEET NUMBER  
8.11 OF 11

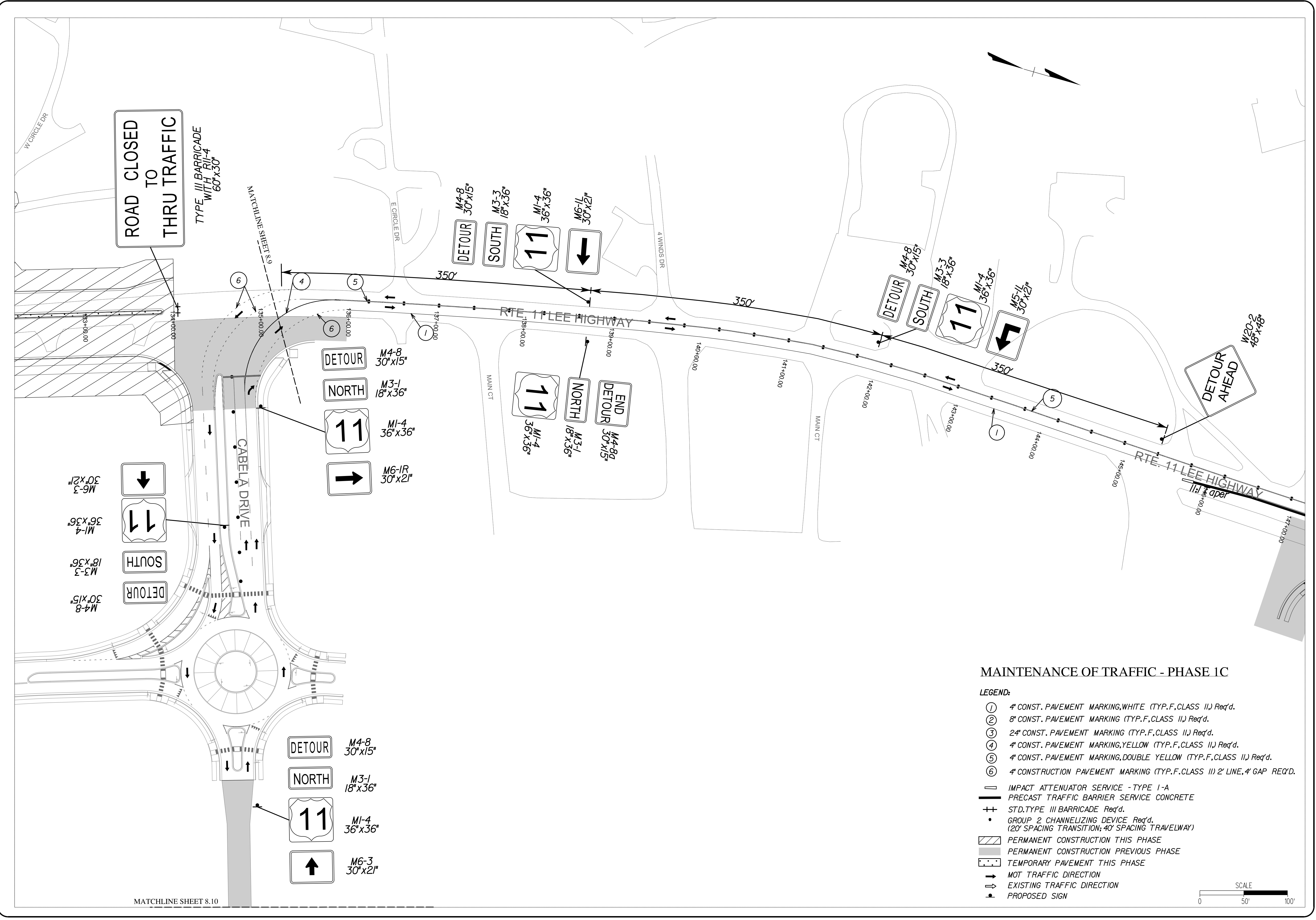

**MAINTENANCE OF TRAFFIC - PHASE 1C**

**LEGEND:**

- ① 4" CONST. PAVEMENT MARKING, WHITE (TYP. F, CLASS II) Req'd.
- ② 8" CONST. PAVEMENT MARKING (TYP. F, CLASS II) Req'd.
- ③ 2" CONST. PAVEMENT MARKING (TYP. F, CLASS II) Req'd.
- ④ 4" CONST. PAVEMENT MARKING, YELLOW (TYP. F, CLASS II) Req'd.
- ⑤ 4" CONST. PAVEMENT MARKING, DOUBLE YELLOW (TYP. F, CLASS II) Req'd.
- ⑥ 4" CONSTRUCTION PAVEMENT MARKING (TYP. F, CLASS II) 2' LINE, 4' GAP REQ'D.
- ▬ IMPACT ATTENUATOR SERVICE - TYPE I-A
- ▬ PRECAST TRAFFIC BARRIER SERVICE CONCRETE
- ++ STD. TYPE III BARRICADE Req'd.
- GROUP 2 CHANNELIZING DEVICE Req'd. (20' SPACING TRANSITION; 40' SPACING TRAVELWAY)
- ▨ PERMANENT CONSTRUCTION THIS PHASE
- ▩ PERMANENT CONSTRUCTION PREVIOUS PHASE
- ▨ TEMPORARY PAVEMENT THIS PHASE
- MOT TRAFFIC DIRECTION
- ⇨ EXISTING TRAFFIC DIRECTION
- PROPOSED SIGN

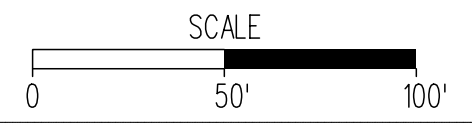

7/17/2017

MATCHLINE SHEET 8.10