

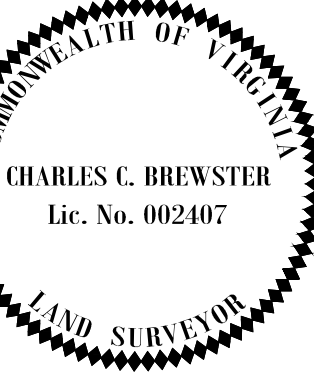

CITY OF  
BRISTOL, VIRGINIA  
300 LEE STREET  
BRISTOL, VA 24201  
(276) 645-7470

REVISIONS

DATE

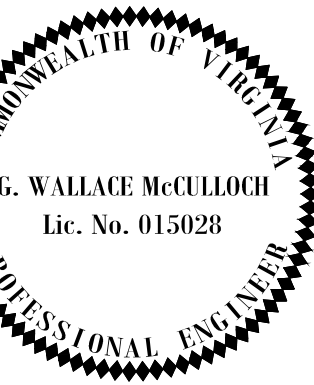

WIDENING OF  
LEE HIGHWAY  
PHASE - 2  
UPC 105753

STORM AND SANITARY  
SEWER LINE PROFILES

DATE:  
JULY 2017  
DRAWING NO.  
T30-229  
FILE NAME:  
LEE HWY EXIT 5

SHEET NUMBER  
11.3 OF 11

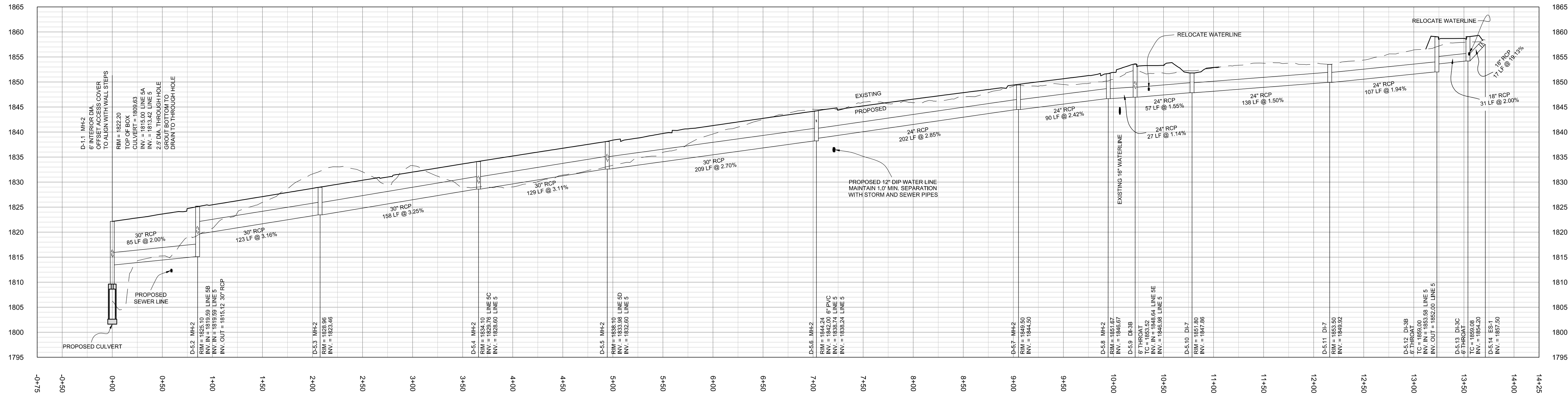

**STORM LINE 5**

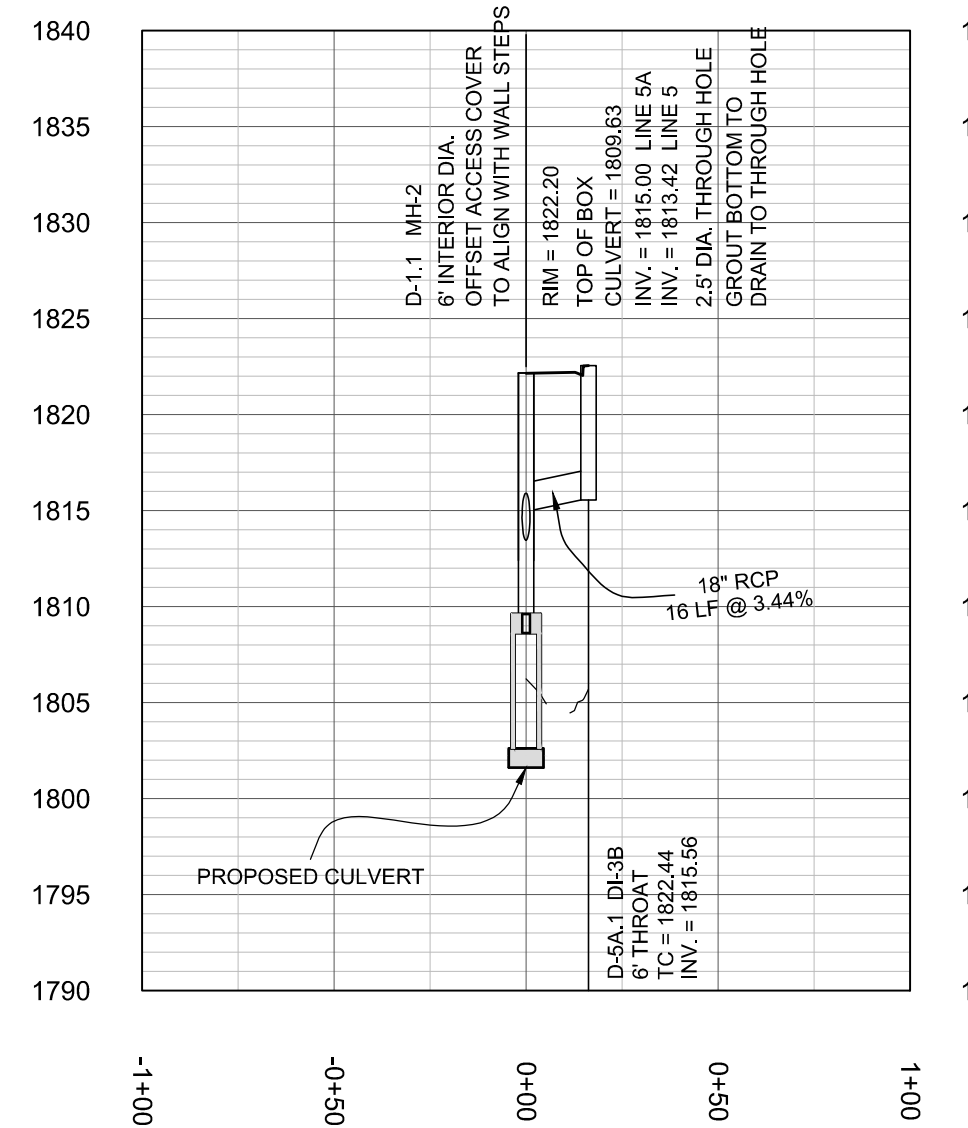

**STORM LINE 5A**

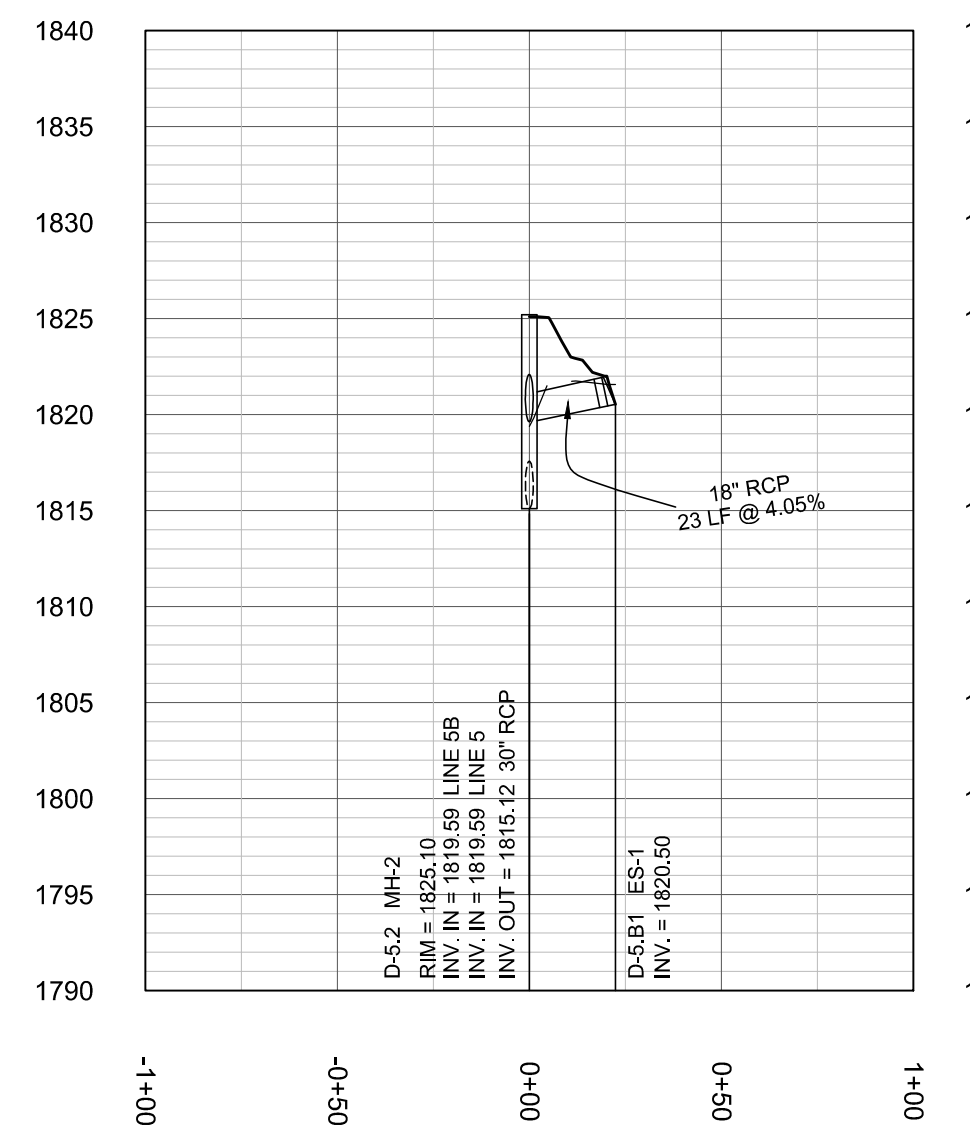

**STORM LINE 5B**

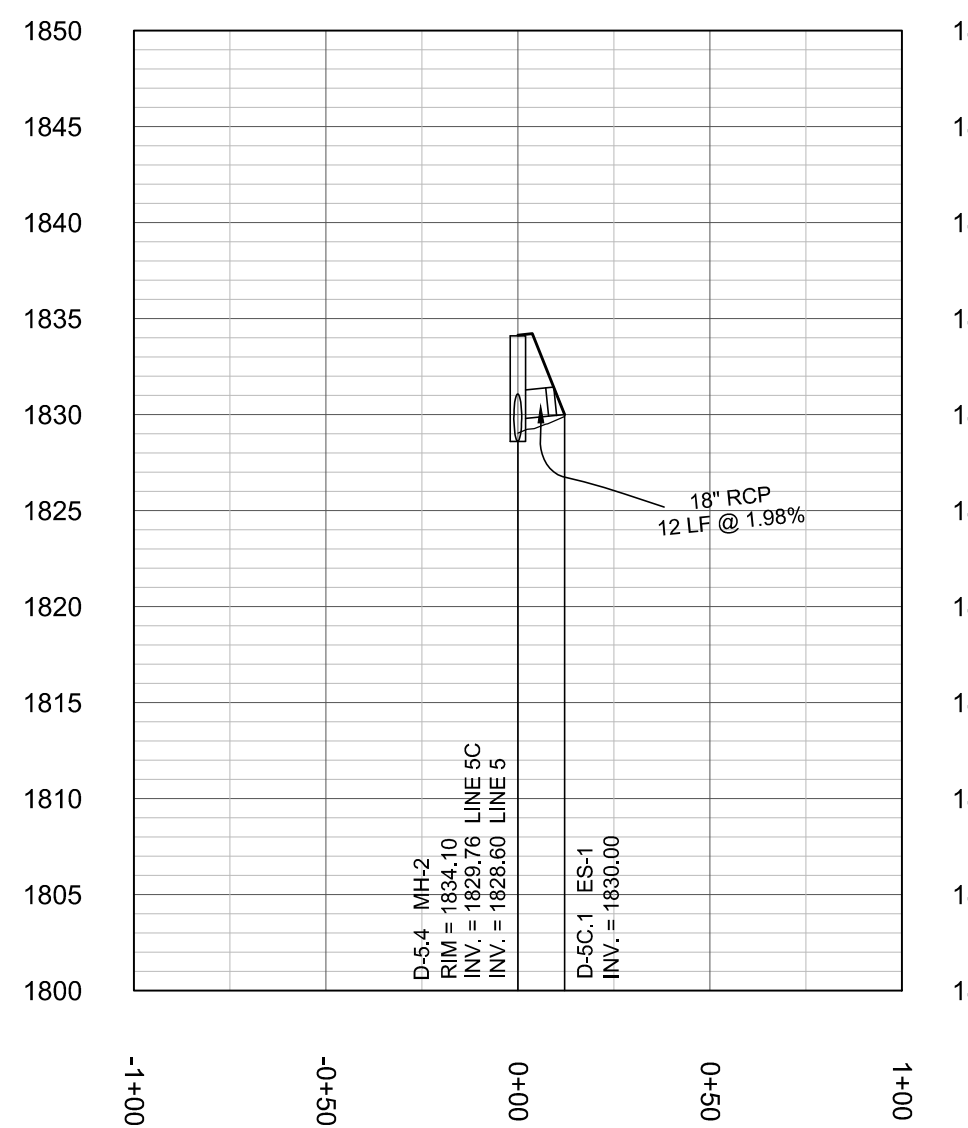

**STORM LINE 5C**

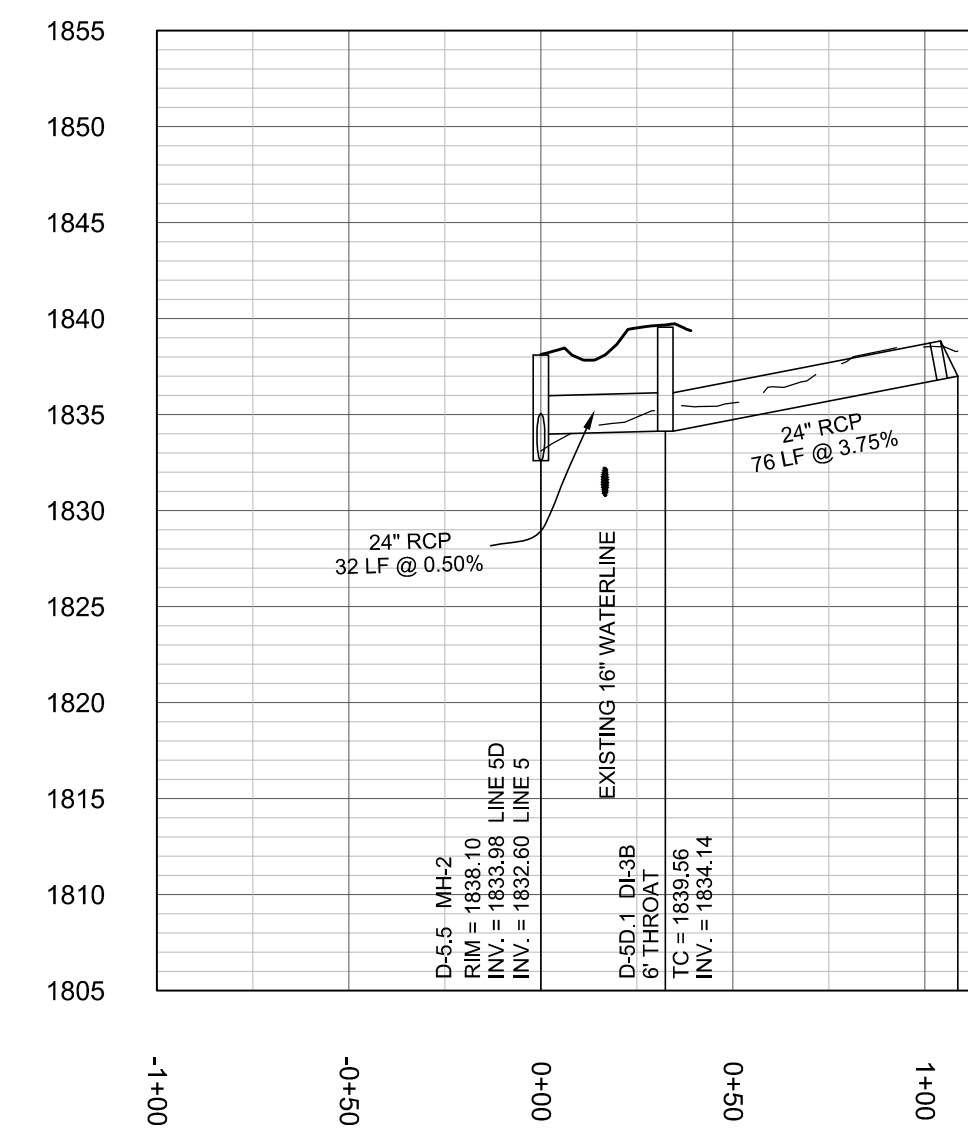

**STORM LINE 5D**